

Estimated Total Finished
 Square Footage: 1,735 SQ FT

Above-Grade: 1,735 SQ FT Below-Grade: N/A
 Plus 1,010 SQ FT 2-Car Garage/Storage on Lower Level
 Calculated per ANSI Standard Z765-2003.

348 LOMBARD STREET

SAN FRANCISCO, CA 94133

* Estimated Total Finished & Unfinished
 Square Footage: 2,745 SQ FT



MAIN LEVEL
 1,355 SQ FT

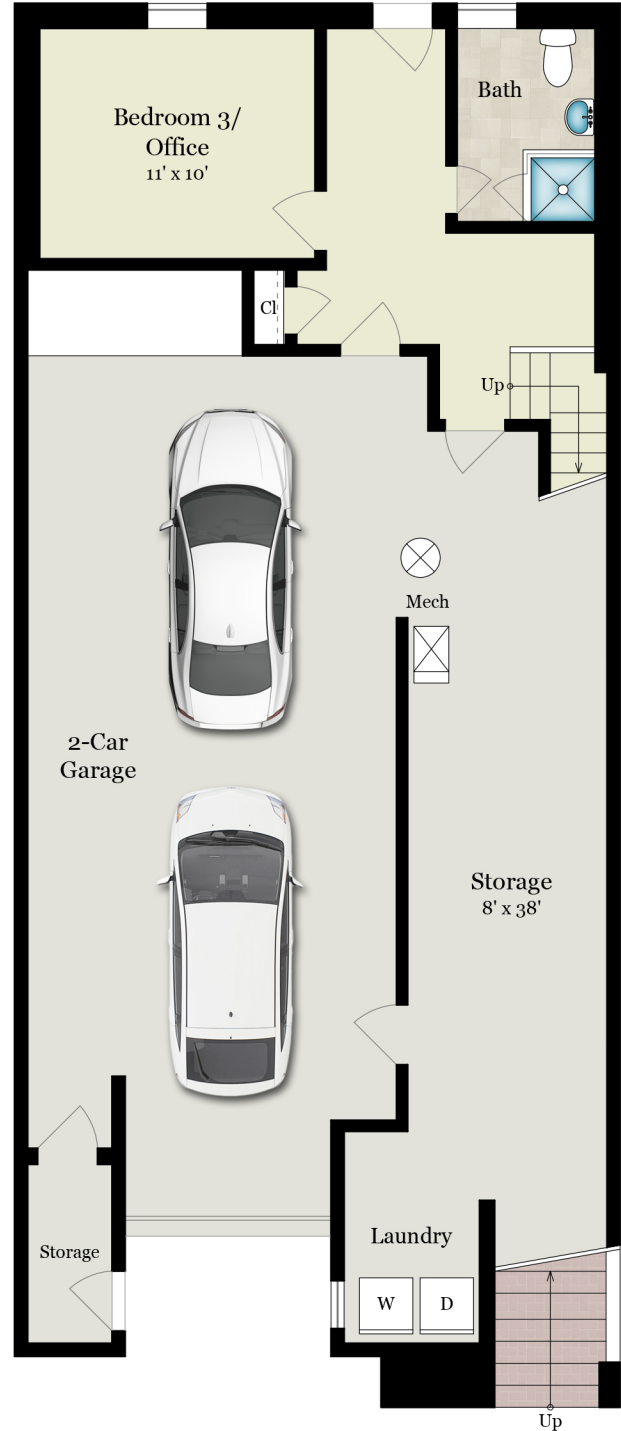

LOWER LEVEL
 380 SQ FT - Finished
 1,010 SQ FT - Unfinished

